



LEVITON®



Omni Security + HomeSeer
HomeSeer integration provides Amazon
Alexa voice control over lighting,
thermostats, and macros.



Omni Security & Automation Systems Integration with HomeSeer HomeTroller

NOW, OMNI CUSTOMERS CAN USE THEIR VOICE TO CONTROL THEIR HOMES

For many years, Omni security & automation systems have been the pinnacle choice for high-end homes and small businesses alike. Customers all over the world choose Omni for the integration possibilities. Now, through an integration with a HomeSeer HomeTroller, Leviton Omni customers can integrate Amazon Alexa voice control using the HomeSeer Smart Home Skill. End-users can issue commands to adjust lighting, temperatures, and macros. To see the step-by-step installation instructions, please visit: <http://communities.leviton.com/docs/DOC-5146>.

CHALLENGE:

Homeowner desires voice control over Omni solution.

- New or existing installation.
- No native integration between Omni and Amazon.

SOLUTION:

Integrate OmniPro II, Omni IIe, and Omni LTE with HomeSeer HomeTroller (S2, SEL, SEL PRO, S6, or S6 PRO).

- Utilize HomeSeer Smart Home Skill.
- Provide voice control over lighting, temperature, and macros for Omni systems.

Leviton Security & Automation 865 Fulton St., Suite 500, New Orleans, LA, 70130

Telephone: 1-504-608-9001 • Tech Line (8:30am -7:00pm E.S.T. Monday-Friday): 1-800-824-3005

Visit our website at: www.leviton.com/automation ©2017 Leviton Manufacturing Co. Inc. All rights reserved.

To Achieve Amazon Alexa Voice Control for Omni Systems

WHAT YOU WILL NEED:

- Omni II Series (Omni LTe, Omni IIe, OmniPro II) controller
- Amazon Echo or Dot
- HomeSeer HomeTroller (S2, SEL, SEL PRO, S6, or S6 PRO) controller, running firmware version 3.0.0.318 or later
- HomeSeer Plug-in for Omni (OMNI Plug-In under Security category)
- MyHomeSeer Remote Web Account

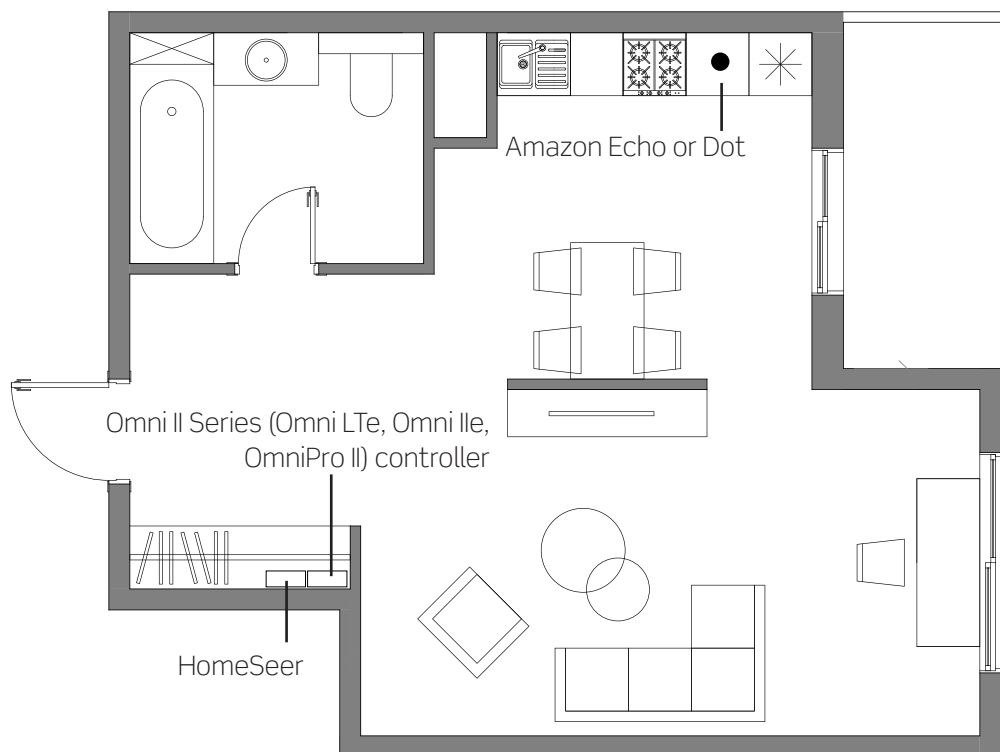

CONTROLLING DEVICES WITH ALEXA:

Lighting

To control lighting with Alexa, you can use the following phrases. In these examples, the name of the unit is Lamp.

- 'Alexa, turn the Lamp on'
- 'Alexa, turn the Lamp off'
- 'Alexa, set the Lamp to 50%'
- 'Alexa, dim the Lamp to 25%'
- 'Alexa, brighten the Lamp to 75%'

Thermostats

To control Omnistat2 thermostat connected to Omni, the following phrases can be used. In these examples, the name of the thermostat is House.

- 'Alexa, set the House temperature to 76 degrees'
- 'Alexa, lower the House temperature by 2 degrees'
- 'Alexa, raise the House temperature by 5 degrees'